



Note: it is recommended that tests are supervised by a Medical Professional

Covdiag Saliva

Rapid saliva antigen test for detecting different strains of coronavirus in 10 minutes.

RELIABLE

- ▶ Detection of N Protein in saliva
- ▶ Detection of strains :
 - English (VOC-202012/01)
 - South African (501.V2)
 - Brazilian (B.1.1.248)

PRACTICAL

- ▶ Individual ready-to-use buffer vial supplied with each test.
- ▶ Painless and non-invasive saliva sampling.

FAST

- ▶ Interpretation time: 10 minutes. Positive results may appear within the first minute.



92,9%
specificity

99,5%
sensitivity

EASY TO USE IN 3 STEPS

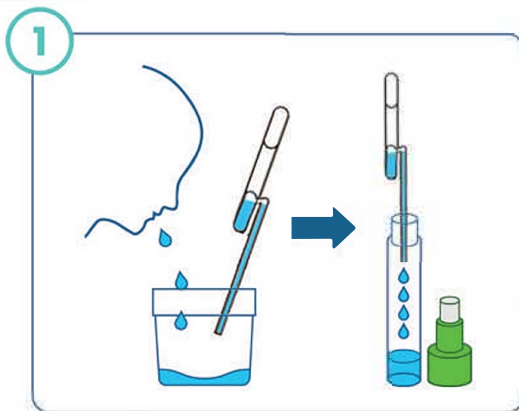

1 Collect saliva in the sampling container. Collect saliva with the pipette until the first reservoir is 3/4 full and place the collected saliva in the tube containing the extraction buffer.

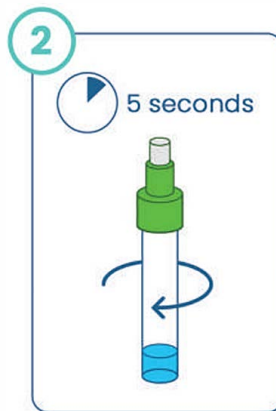

2 Close the tube and mix gently for 5 seconds.

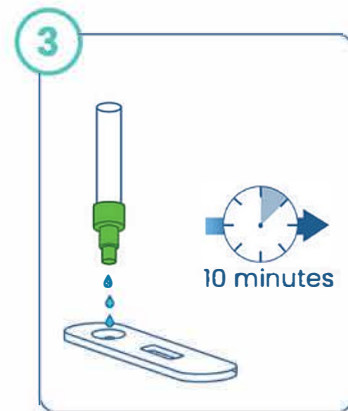

3 Place 3 drops in the sample well of the test and start the timer. Read the results after 10 minutes.

RESULTS INTERPRETATION

C	+	T	+	Positive	POSITIVE: Two colored lines appear. A colored line should always appear in the region of the control line (C) and another line in the region (T).
C	+	T	-	Negative	NEGATIVE: A colored line appears in the control line area (C). No line appears in the region (T)
C	-	T	+	Invalid	INVALID: A line in the Test (T) area appears. No line in the Control (C) zone. Repeat the test with a new device.

